

## Angular Contact Ball Bearings

### Brass cage angular contact ball bearing-7216 BECBP

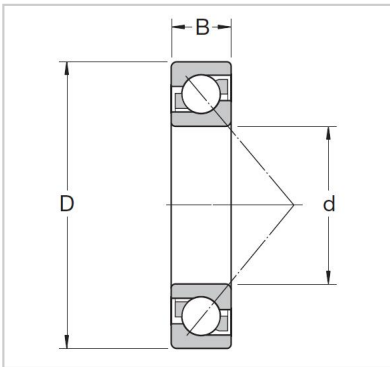

#### Abutment and fillet dimensions

Db max.	<b>7216 BECBP</b>
Da max.	-
da min.	80
rb max.	140
ra max.	26

#### Dimensions

a	85
r3,4 min.	75
r1,2 min	3.05
D1	5 600
d2	5 600
d1	1.45

#### Mass

KG	103
----	-----

#### Speed ratings r/min

Limiting speed	91.4
Reference speed	118

#### Fatigue load limit

Pu kN	<b>2</b>
-------	----------

#### Basic load ratings KN

dynamic C kN	<b>1</b>
static Co kN	59

#### Basic design bearing

B mm	91
D mm	130
d mm	134

#### Basic design bearing

	<b>2</b>
--	----------

#### Designations

Universally matchable bearing	<b>1</b>
-------------------------------	----------